



Straight Stack: Steel First Installation Guide

Look for this sticker
on hardware bags

FLIGHT



Tools & Supplies Needed for this Installation

- Right Angle Drill
- Hammer Drill (*Concrete Header or Footer*)
- Impact Driver
- Torque Wrench
- Socket Wrench
- Pencil/Marker
- $\frac{1}{64}$ " Wood Drill Bit
- Concrete Drill Bit (*Concrete Header or Footer*)
- $\frac{9}{16}$ " Sockets
- T-30 Torx Socket
- Socket Extension
- $\frac{3}{16}$ " Allen Wrench
- Level
- Framing Square
- Measuring Tape
- Table Saw

Things to Know Before You Get Started

- Before you get started, review your print set, specifically reviewing the steel exploded assembly print(s) and the wood exploded assembly print(s)
- Read over the provided material prior to the start of your installation
- This is, at minimum, a two person job
- Viewrail Glass systems and fittings are designed to have a 1" gap between panels of glass



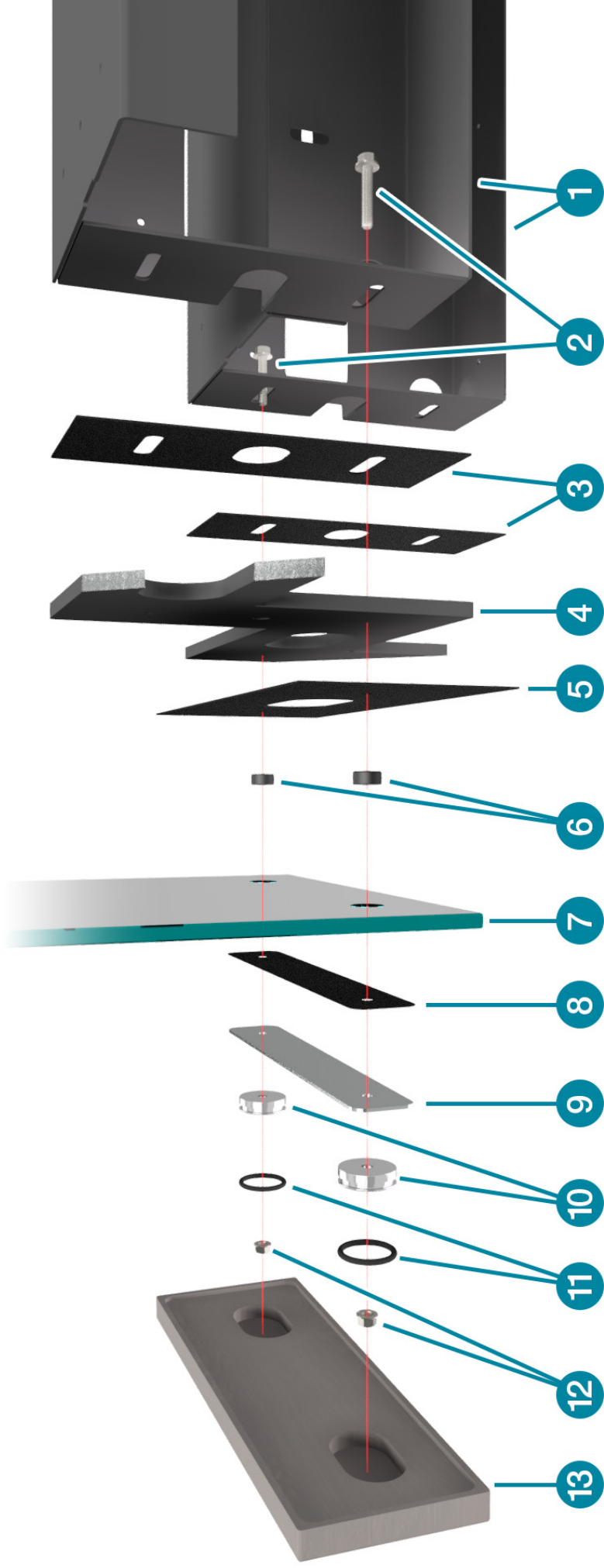

1	Tread Pans	8	Vedera Gasket
2	$\frac{3}{8}$ " x 2" Hex Head Flange Bolt	9	Vedera Plate
3	Tread Pan Gaskets	10	Vedera Glass End Caps
4	Steel Stringer	11	Vedera O Rings
5	Tread Gasket	12	$\frac{3}{8}$ " Serrated Flange Nuts
6	Nylon Bushings	13	Tread Cap
7	Glass		

Straight Stack: Steel First Installation Steps

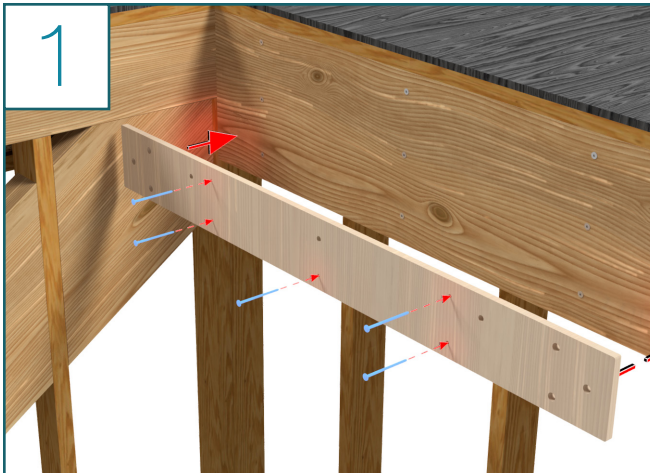

- Per the provided plans, locate the called out Finished Floor to the top of Plywood Header Template measurement & mark where the template will be placed
- Hold the Plywood Template in place, drive 5 wood screws to secure the template to the header

Note on Blocking: Plywood Templates must be mounted directly to either double LVL or Triple 2x. If the wall has a compressible surface, e.g. drywall, it must be cut away before hand.

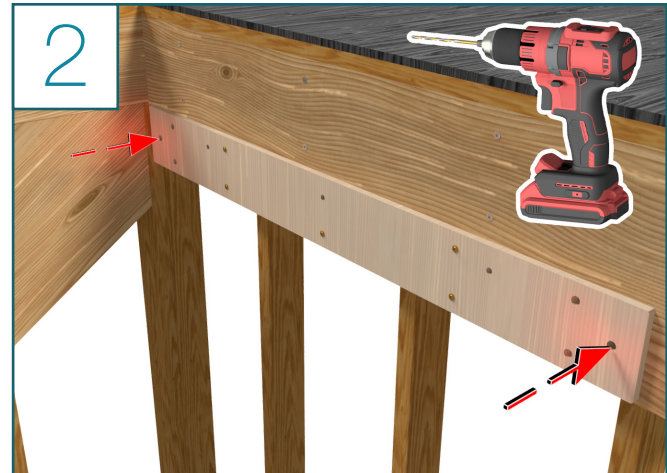

- Predrill the 2 outside holes in the Plywood Header Template using a $1\frac{1}{64}$ " drill bit

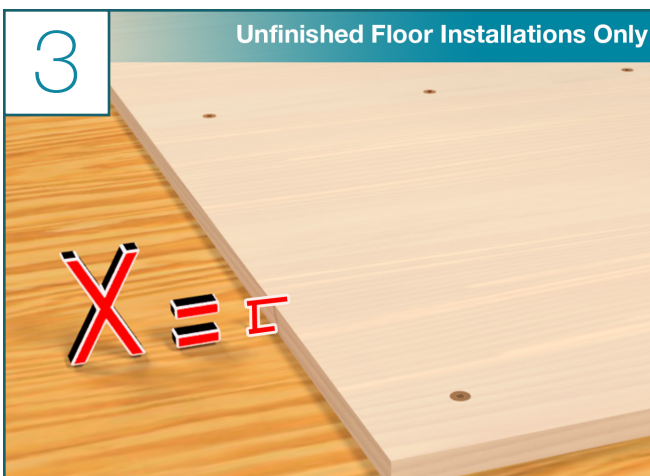

- If finished flooring is not yet installed, add subfloor material equal to the finished floor thickness (X) beneath the stringer feet and under tread pans 1 and 2

Note: X = thickness of the finished floor

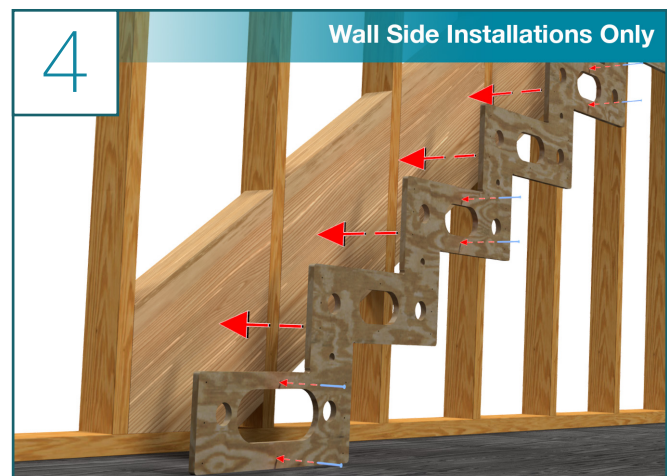

- Line up the top of the Plywood Stringer Template with the top of the Plywood Header Template
- While it is held in place, secure it to the wall backing using wood screws - it is not necessary to populate every hole, just enough to secure it for now

Note on Blocking: Plywood Templates must be mounted directly to either double LVL or Triple 2x. If the wall has a compressible surface, e.g. drywall, it must be cut away before hand.

Straight Stack: Steel First Installation Steps (Continued)

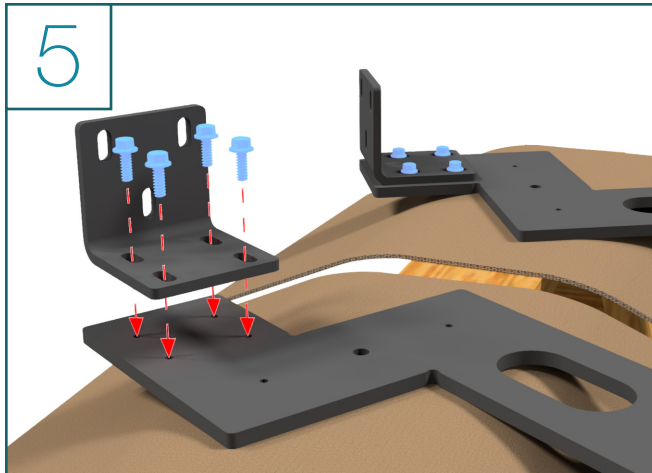

- Place steel stringers on sawhorses
- Attach the header brackets as shown using the provided $\frac{3}{8}$ " x 1" bolts
- Tighten bolts just until snug

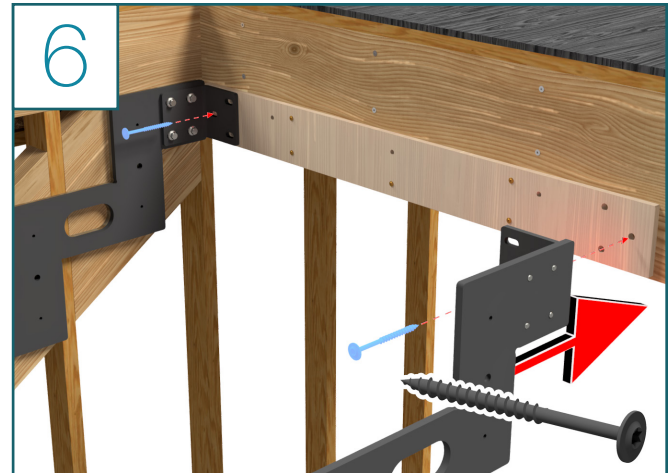

- Hoist the stringers & line them up with the large holes predrilled in the Plywood Header Template
- Fix them in place with one $\frac{3}{8}$ " x 5" SPAX Screw each in the predrilled locations from **STEP 2**

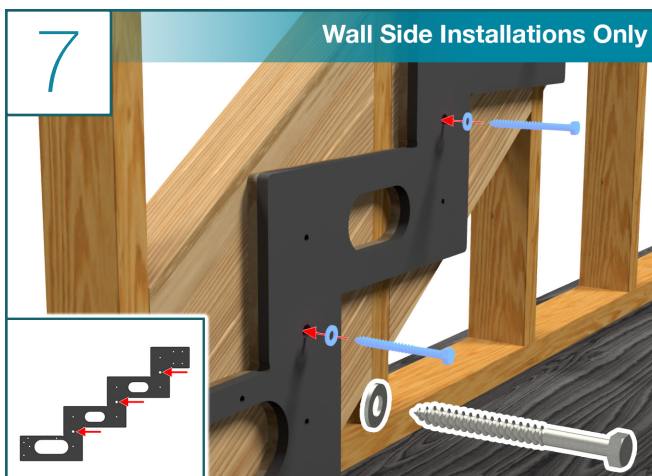

- For installations up against a wall, align and secure the steel stringer to the wood template using the provided $\frac{3}{8}$ "-7 x 4" Hex Head Lag Screws and washers

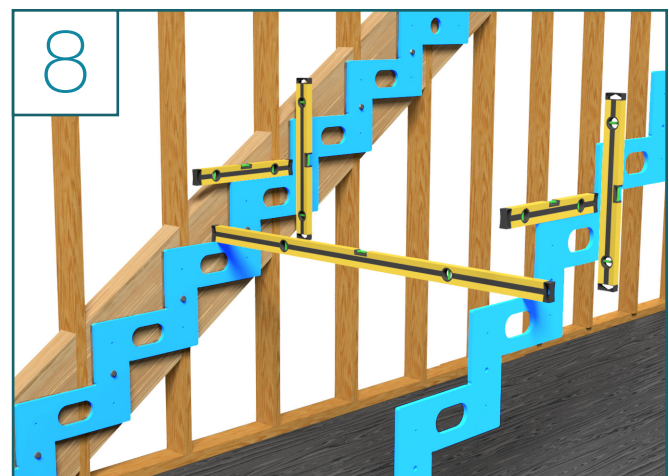

- Check for plumb on all 3 axis for each stringer
- Shim if necessary



It is imperative that the stringers are level & plumb, even if your wall/floor is not.

Straight Stack: Steel First Installation Steps (Continued)

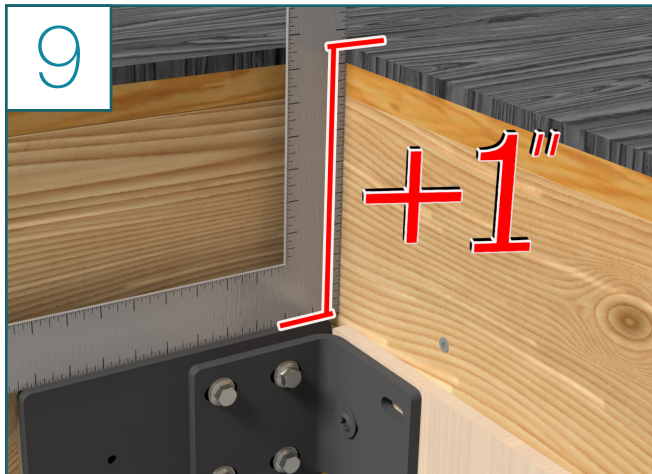

- Take this time to ensure that the measurement of the top rise is correct
- The measurement taken in this step should be 1" long of the Rise measurement on the provided plans - This is to account for the thickness of the finished wood tread to be placed in a later step

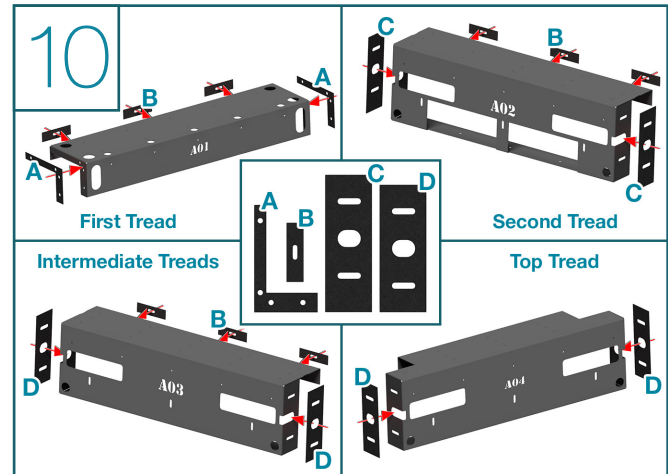

- Collect all Tread Pans and Tread Pan Gaskets and attach them together

Note: Each Tread Pan requires gaskets. Tread Pans are labeled with a letter and number. The letter indicates the stair system, & the number indicates position.

Tread Pan	Description	Gaskets Used
_01	First Tread Pan	(2) A's, (3) B's
_02	Second Tread Pan	(2) C's, (3) B's
_03	Intermediate Tread Pans	(2) D's, (3) B's
_04	Top Tread Pan	(2) D's

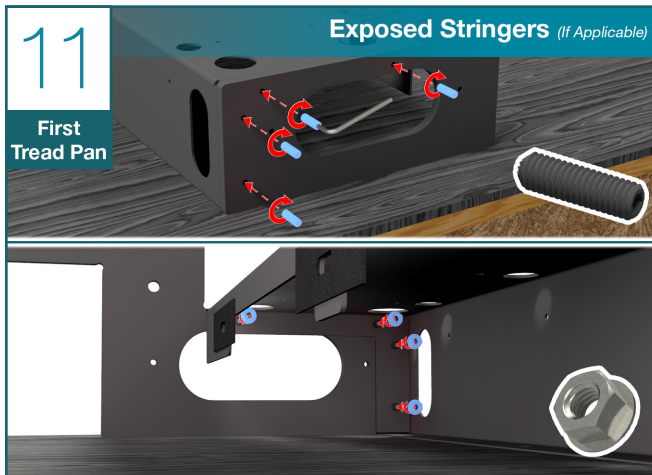

- Place the First Tread Pan, (e.g. A01, B01, C01 etc.)
- Thread (4) of the provided $\frac{3}{8}$ " -16 x $1\frac{1}{4}$ " set screws from the outside of the free standing stringer
- Thread on (4) of the provided $\frac{3}{8}$ " -16 Hex Head Serrated Flange Nuts onto each set screw from underneath
- **DO NOT** tighten bolts all the way down in this step

*Notes: On stringers that are not butted up to a wall, it will be easier to insert set screws from the outside.
Due to the powder-coating process, you may need to run a $\frac{3}{8}$ " -16 bolt through the threaded holes on the stringers before mounting the tread pan, to clear the threads.*

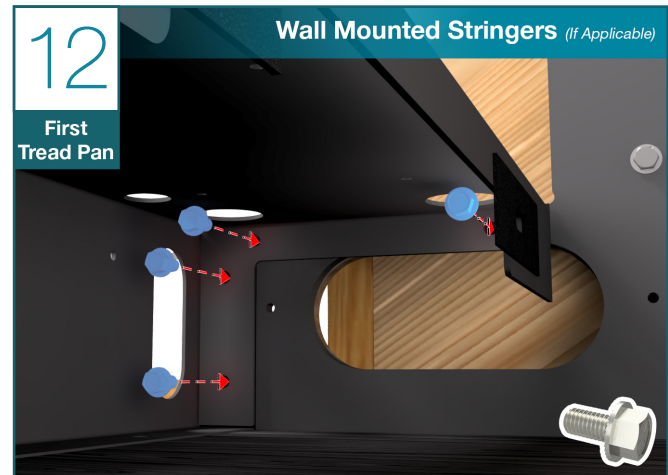

- Using (4) $\frac{3}{8}$ " -16 x $\frac{3}{4}$ " Hex Head Bolts secure the wall side of the tread pan to the metal stringer
- **DO NOT** tighten bolts all the way down in this step

Straight Stack: Steel First Installation Steps (Continued)

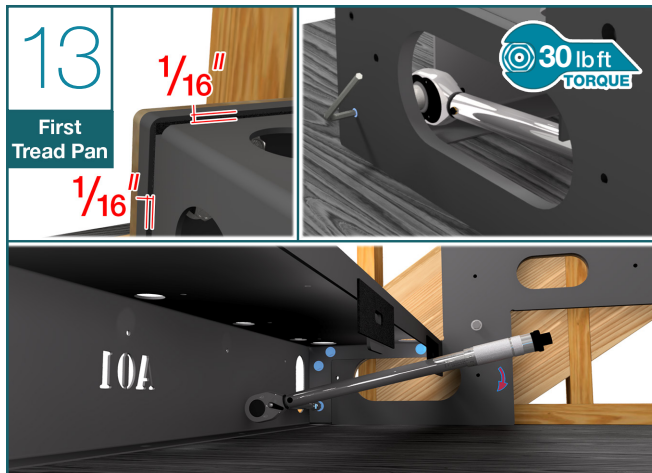

- Ensure the tread pan is level and recessed $\frac{1}{16}$ " from the top and front edges of the steel stringers
- Torque the hardware placed in **STEPS 11 & 12** to 30 lb-ft

Note: It may be necessary to use an socket extension to reach the nuts and bolts under the tread pan

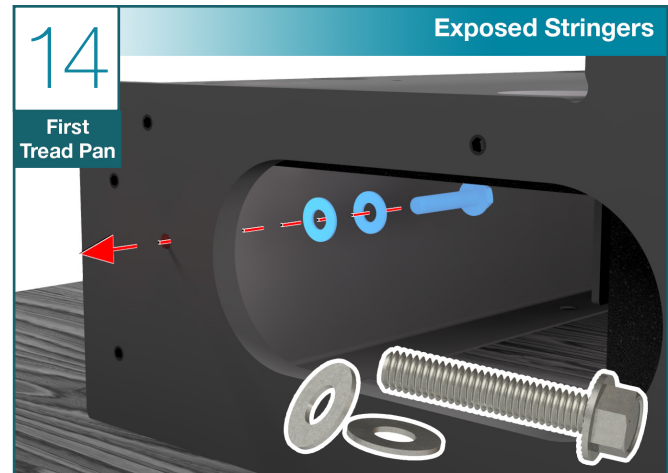

- Using (2) of the supplied $\frac{3}{8}$ " Washers

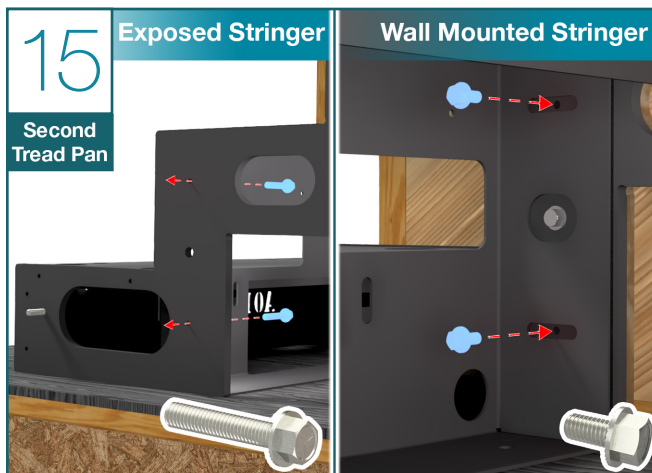

- Slide the Second Tread Pan (e.g. A02, B02, C03, etc.) into position behind the tread pan installed in the previous steps
- **Exposed Stringers:** Use (3) $\frac{3}{8}$ " -16 x 2" Hex Head Bolts secure the pan, through the (2) slots in the side of the pan, into the stringer from under the pan
- **Wall Mounted Stringers:** Use (2) $\frac{3}{8}$ " -16 x $\frac{3}{4}$ " Hex Head Bolts secure the pan, through the (2) slots in the side of the pan, into the stringer from under the pan
- **DO NOT** tighten bolts all the way down in this step



- Using (3) of the provided $\frac{3}{8}$ " -16 x 2" Hex Head Serrated Flange Bolts secure the pan, through the (3) slots in front of the pan as shown above
- **DO NOT** tighten bolts all the way down in this step

Straight Stack: Steel First Installation Steps (Continued)

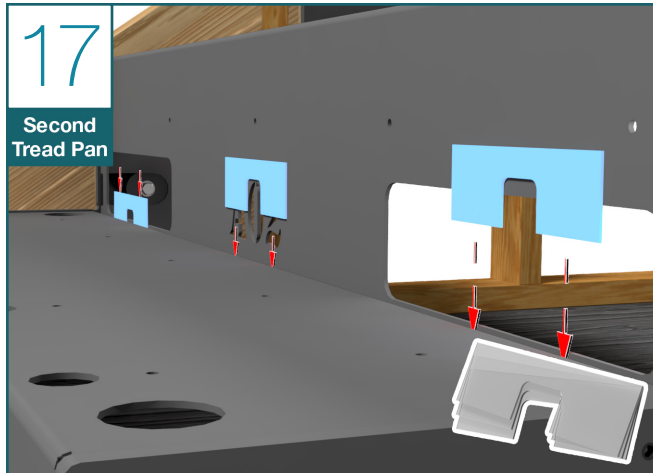

- Slide the Polycarbonate Shims into place between the First and Second Tread Pan

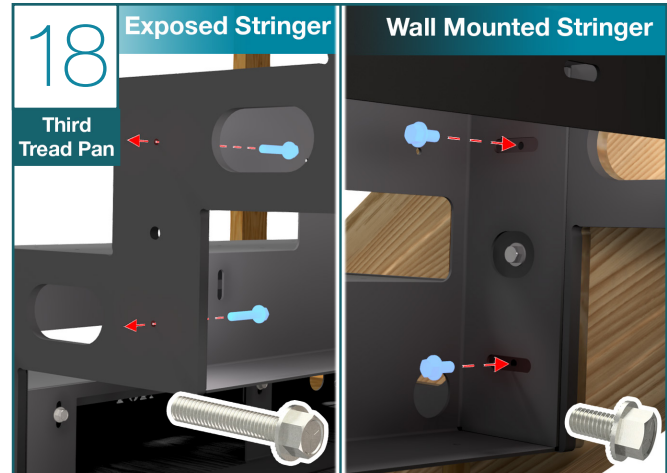

- Slide the Third Tread Pan (e.g. A03, B03, C03, etc.) into position behind the tread pan installed in the previous steps
- **Exposed Stringers:** Use (2) $\frac{3}{8}$ " -16 x 2" Hex Head Bolts secure the pan, through the (2) slots in the side of the pan, into the stringer from under the pan
- **Wall Mounted Stringers:** Use (2) $\frac{3}{8}$ " -16 x $\frac{3}{4}$ " Hex Head Bolts secure the pan, through the (2) slots in the side of the pan, into the stringer from under the pan
- **DO NOT** tighten bolts all the way down in this step

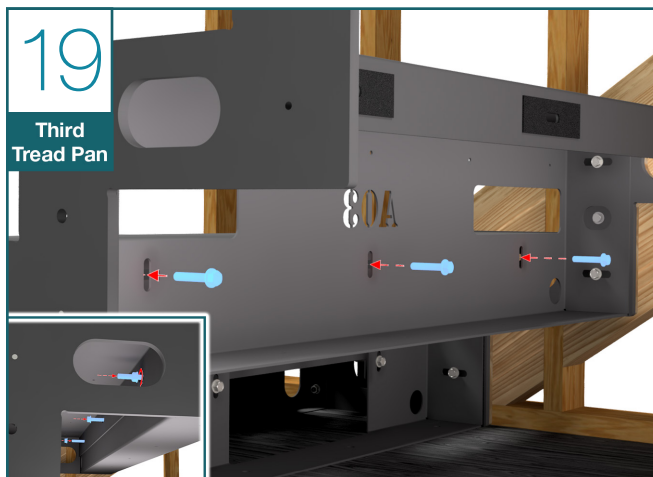

- Using (3) of the provided $\frac{3}{8}$ " -16 x 2" Hex Head Serrated Flange Bolts secure the pan, through the (3) slots in front of the pan as shown above
- **DO NOT** tighten bolts all the way down in this step



- Slide the Polycarbonate Shims into place between the Second and Third Tread Pan

Straight Stack: Steel First Installation Steps (Continued)

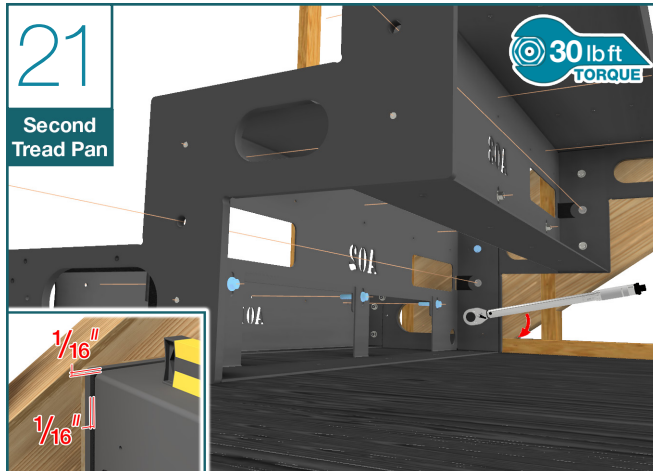

- Return back to the Second Tread Pan and ensure that it is level and recessed $\frac{1}{16}$ " from the top and front edges of the steel stringers
- Torque the all (7) $\frac{3}{8}$ " bolts installed from **STEPS 14-16**, to 30 lb-ft

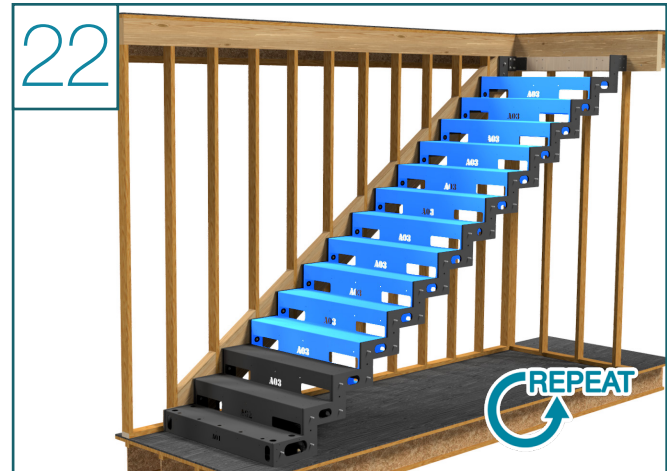

- Repeat **STEPS 17-20** for the remaining intermediate tread pans (e.g. A04) Following the pattern below

*e.g. Install 4th Tread Pan & square it up
Torque down 3th Tread Pan
Install 5th Tread Pan & square it up
Torque down 4th Tread Pan
Install 6th Tread Pan & square up
Torque down 5th Tread Pan, etc.*



- Now move up to the header area and predrill the (4) remaining holes through the Plywood Header Template using a $\frac{11}{64}$ " drill bit



- Install the top Tread Pan (e.g. A04, B04, C04, etc.) just like the others using the same hardware
- Leave hardware loose for now

Straight Stack: Steel First Installation Steps (Continued)

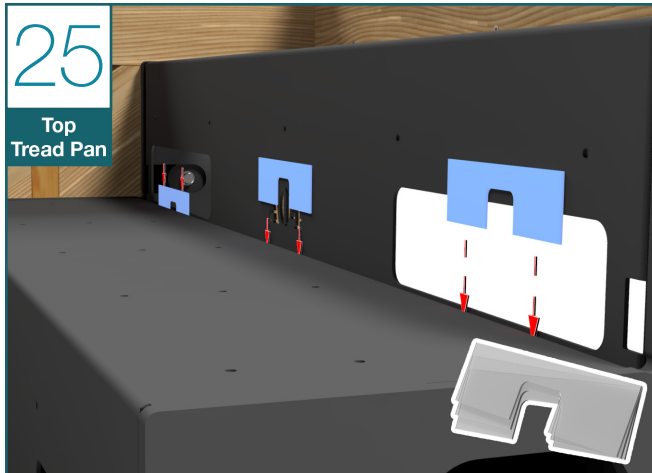

- Slide the Polycarbonate Shims into place between the top most intermediate tread pan (e.g. A03) and the Top Tread Pan (e.g. A04)



- Torque the all (7) $\frac{3}{8}$ " bolts installed from **STEP 24**, to 30 lb-ft

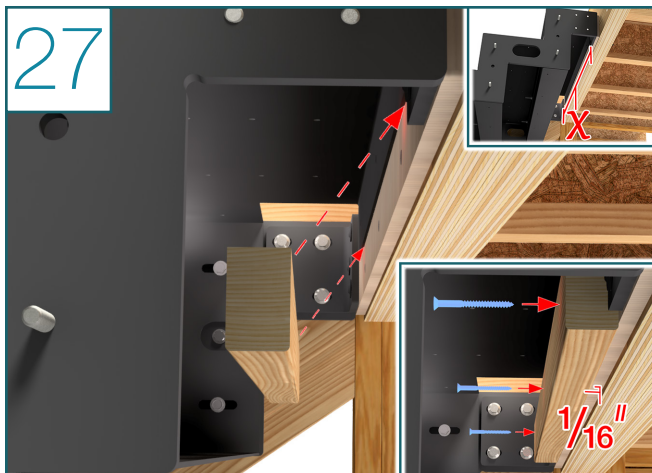

- Cut the provided Header Frame Brace to the measurement indicated above (X)
- Install it into place using wood screws - This will be used to attached the finished Anti-Run wood in a later step

Note: Make sure to center the wood in between the Metal Header Brackets and $\frac{1}{16}$ " from the bottom of the steel stringer itself. The steel stringer sitting lower than the wood Header Frame Brace.

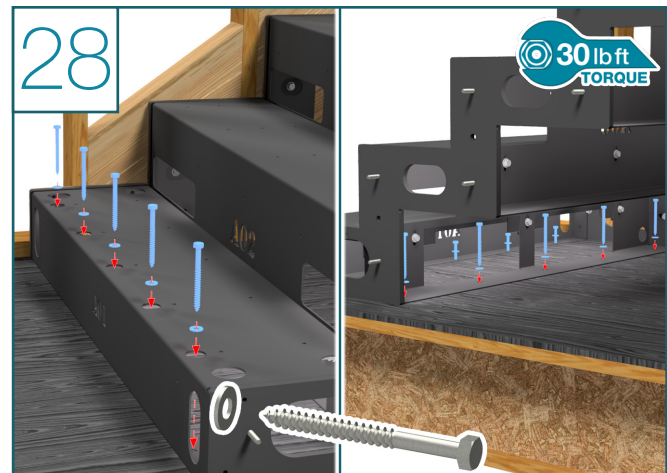

- Secure the first and second Tread Pans using (10) of the provided $\frac{3}{8}$ "-7 x 4" Hex Head Lag Screws and washers
- Torque to 30 lb-ft



If you received all of your order including the finished wood treads and glass panels, skip ahead to **STEP 36**