

## Tools Needed for this Installation



$\frac{3}{16}$ " Allen Wrench



Glass Suction  
Cup Handles

## Things to Know Before You Get Started

- Read over the provided material prior to the start of your installation.
- This project requires a minimum of two people.
- Please note, for best results store glass hardware at room temperature (68°F+ ) up to the point of install. Cold weather can cause the rubber material to shrink and lose flexibility and grip. This could cause the glass panel to slip and require retightening in the future. Installation during warmer weather is ideal.
- When tightening the glass clips, be sure to tighten by hand, as power tools can damage the screws.



## Glass Clip Installation Steps

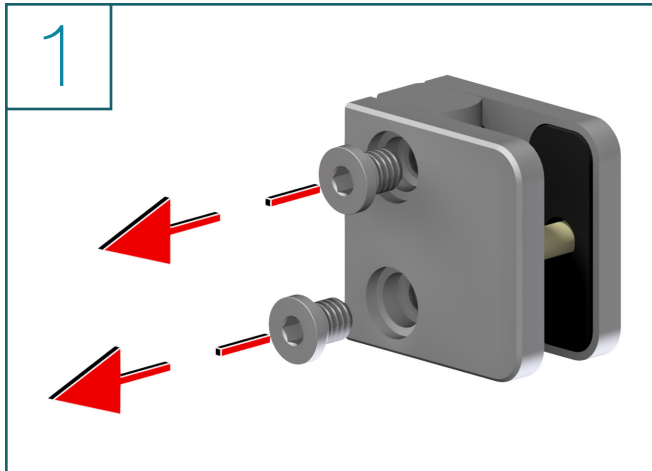

- Locate and prepare your glass clips
- Using the  $\frac{3}{16}$ " Allen wrench, remove the two bolts from one side

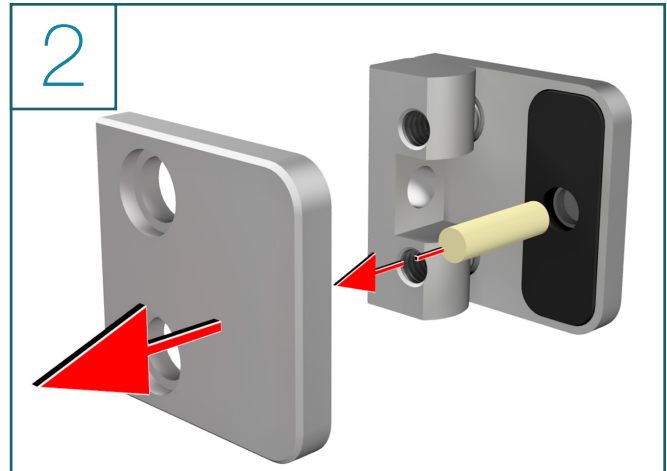

- If you do not have slots or holes in your glass, remove the middle pin
- Slots are usually only needed for side mounted, post to post glass

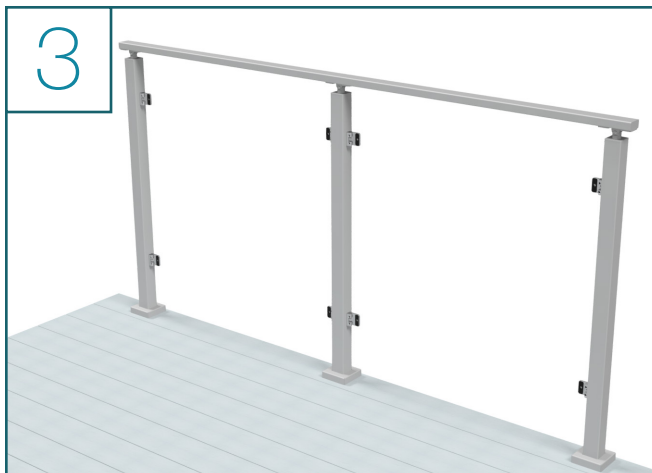

- Make sure the open face of the clip is facing the surface you will be mounting the glass from
- Repeat these steps for the remaining posts on the run you will be working on

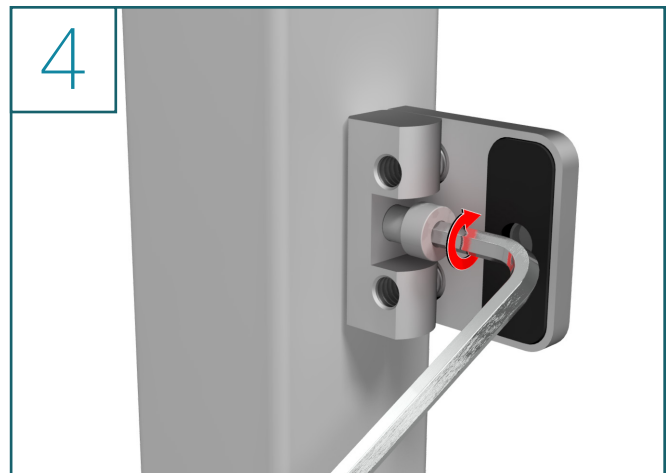

- Using the  $\frac{3}{16}$ " Allen Wrench, attach the larger glass clip half to the post

## Glass Clip Installation Steps (Continued)

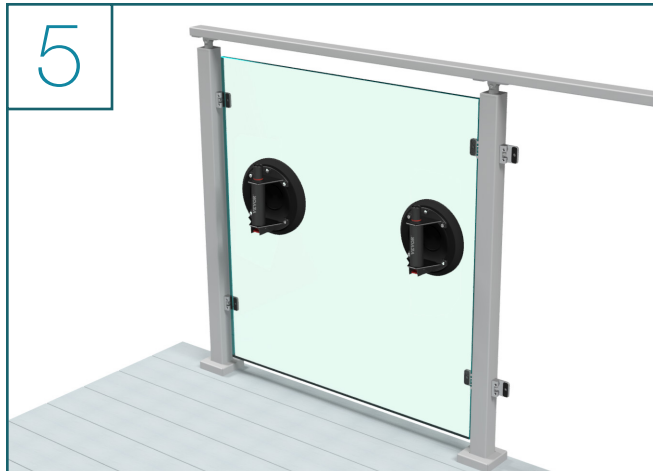

- Using the provided suction cups, identify and move the relevant glass panel into place
- Refer to your provided shop drawings to find the needed panel

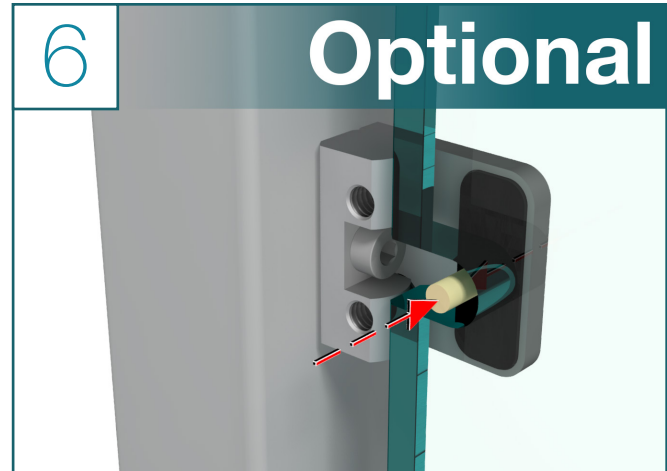

### Optional Step for Side Mount Posts

- Insert a nylon lock pin into each glass slot

#### Note:

*Glass will only have slots when using with our side mounts posts. This step can be skipped on surface mount posts.*

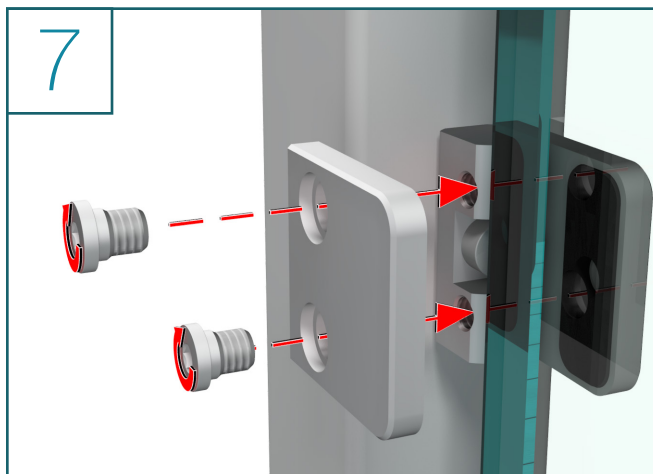

- While one person holds the glass in place, begin reattaching the other glass clip half
- Use the  $\frac{3}{16}$ " Allen wrench to tighten each bolt snugly

#### Note:

*It is helpful to tighten each glass clip until snug, & then go back and retighten them until they are very tight. This will help keep the panel straight.*

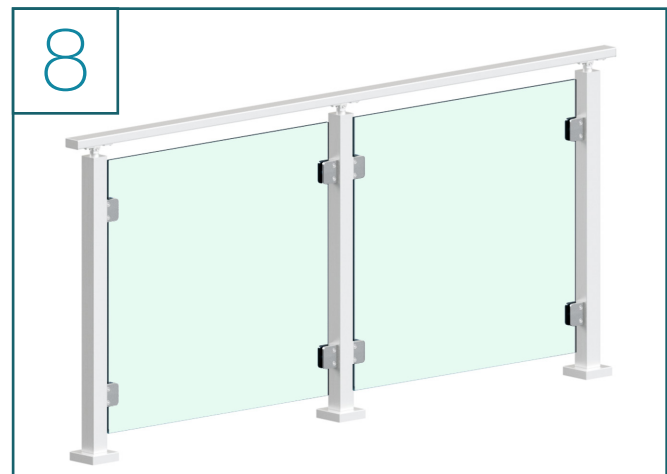

- Repeat these steps for the rest of the run

## Congratulations! You're done with this section.

We'd love to see your work! Snap a few pics with your phone and send them to [pictures@viewrail.com](mailto:pictures@viewrail.com). Thanks for choosing Viewrail. Enjoy your new installation!