

## Tools Needed from the Installation Kit



Glass Suction Cup  
Handles



Custom Short Base Rail  
Wrench



Custom Long Base Rail  
Wrench

## Other Tools and Supplies Not Included in the Installation Kit

- Pencil
- Tape Measure
- Level
- Rubber Mallet
- Knife/Scissors
- Drill
- 3/4" Socket Wrench/Bit
- Silicon/Epoxy
- Miter Saw

## Things to Know Before You Get Started

- Read over the provided material prior to the start of your installation
- Viewrail Glass systems and fittings are designed to have a 1" gap between panels of glass



## Glass Base Rail Installation Steps

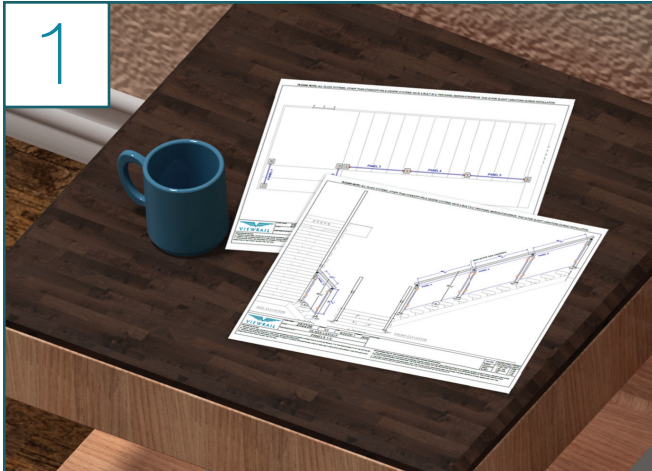

- Refer to your detailed project drawing and quote list to identify the parts needed
- Prepare the parts for each run you will be working on

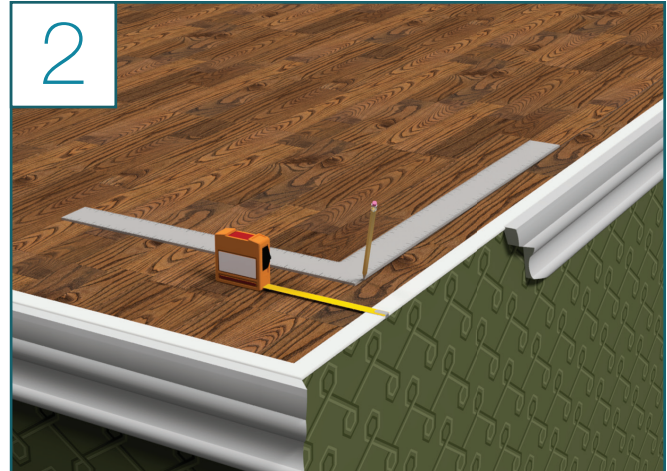

- Measure the distance from the edge of the mounting surface where you will mount the Base Rail
- Mark accordingly across the surface
- Use a chalk line to mark your full run location

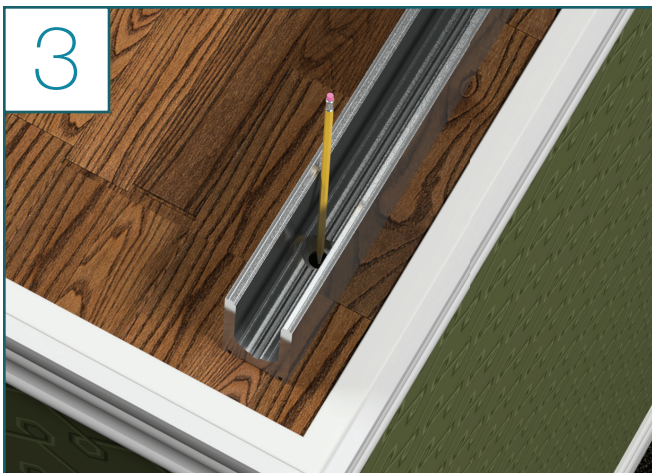

- Place your base rail parts in place so you can see the chalk line through the mounting holes
- When in place, use a pencil or pen to mark your centerline holes



- Remove the Base Rail and use a  $\frac{3}{8}$ " drill bit to drill  $3\frac{1}{2}$ " down in each marked location

## Glass Base Rail Installation Steps (Continued)

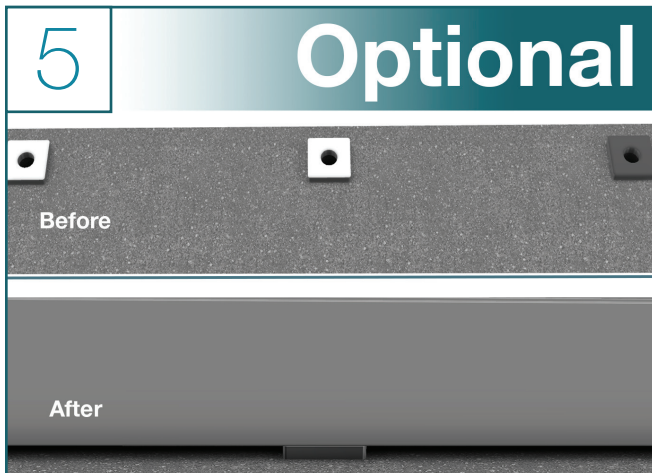

- For exterior decking that does not adequate drainage, the Base Rail Drain Block may be used to allow water to seep under the baserail
- To install, place each shim over the previously drilled holes and continue with your installation



- It may be necessary to cut the base rail to length
- It is important to leave at least 2 mounting holes on the part of the base rail you intend to use
- The minimum length that can be used 18½"
- If you need a smaller section then, you would need to cut the preceding base rail down as well to allow for the next piece to be able to be mounted securely

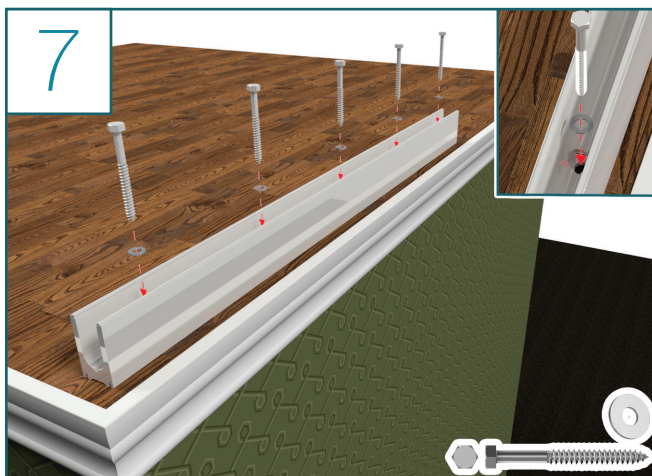

- Place your base rail where it will be mounted down
- Set the mounting washer into the mounting hole
- Using a ¾" socket wrench fasten the ½" x 4" lag down into your surface, repeat this for each mounting location on this Base Rail

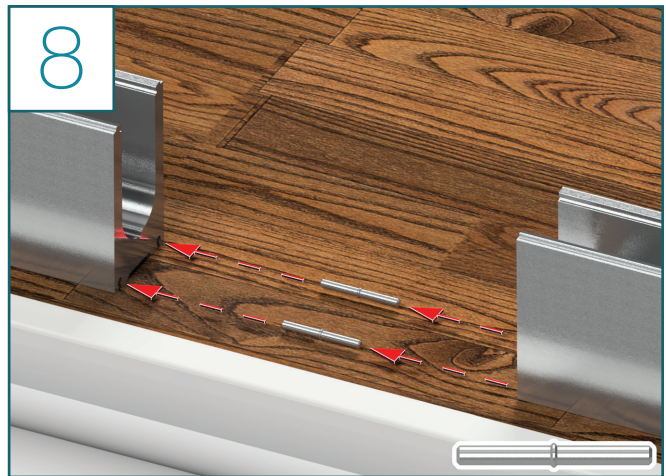

- Where two Base Rail lengths butt up against each other, you will need to use the joining pins to connect them
- Connect the two Base Rail lengths by sliding them together. The raised edge on the joining pin will cause a slight gap. This is not a problem for installation
- Connect the two Base Rails together and repeat steps 1-6 for the new Base Rail length

Glass Base Rail Installation Steps (Continued)

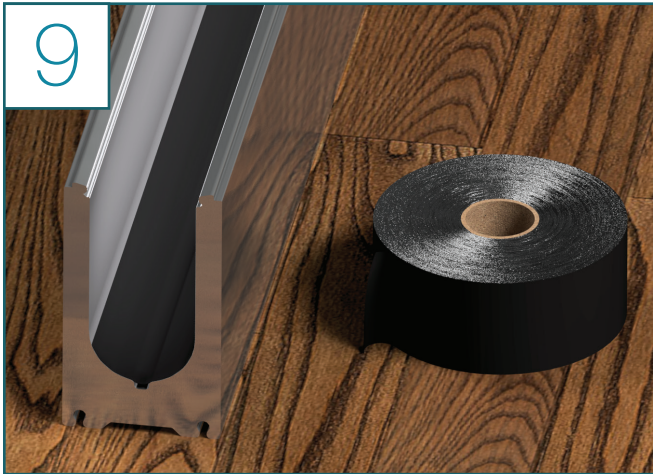

- Run a strip of the supplied 3M™ Super 88 Vinyl Tape down the center of each base rail channel

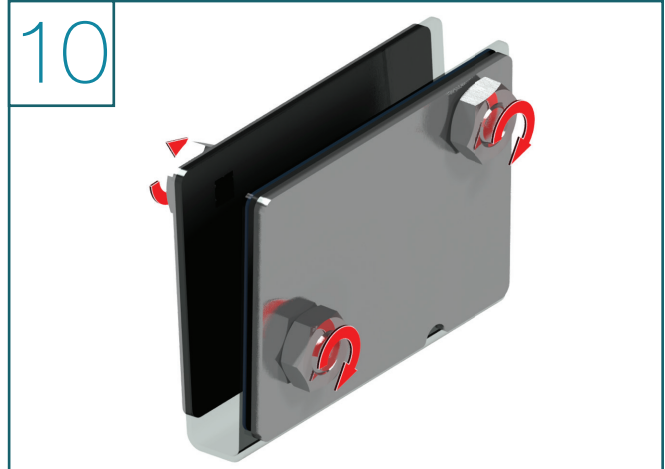

- Prepare the glass clamp assemblies by screwing the nuts up the metal plate they are mounted on
- This will allow the clamp to fit in the base rail, and the glass to fit in the clamp

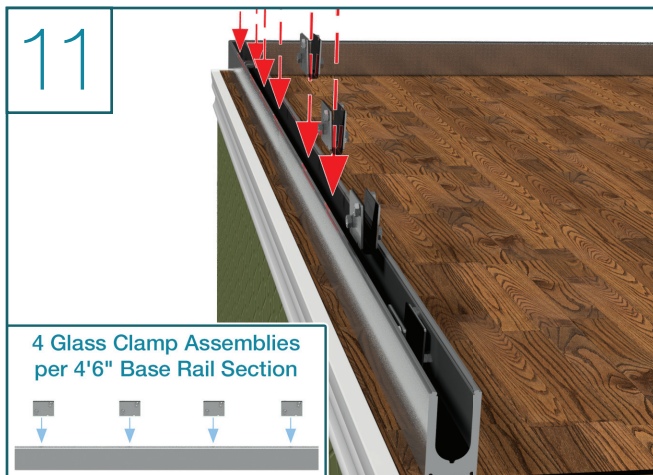

- When all your base rails are mounted down, place all the glass clamp assemblies into the channel
- You will use 4 glass clamp assemblies for every 4'6" base rail section

*Note:*  
You may not need to use all 4 class clamps on smaller custom cut sections of base rail

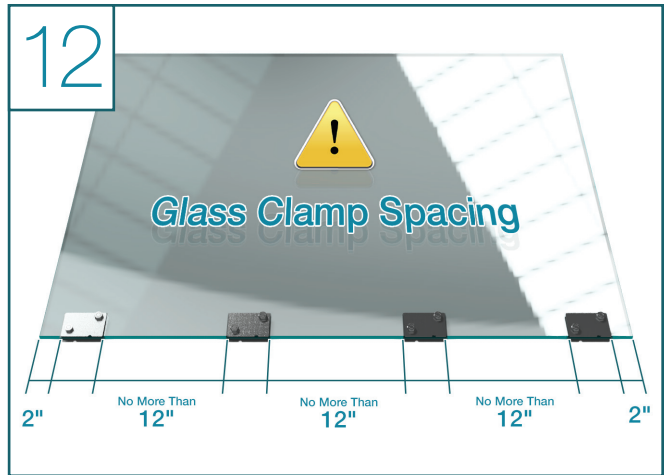

- For the strongest installation, make sure to follow the glass clamp assembly spacing outlined above
- For sections that have to be cut down to fit the run, the rule of thumb is to ensure you have a glass clamp 2" from each edge of the glass panel and space the remaining clips no further than 12" apart

*Note:*  
You may not need to use all 4 glass clamps on smaller custom cut sections of base rail

### Glass Base Rail Installation Steps (Continued)

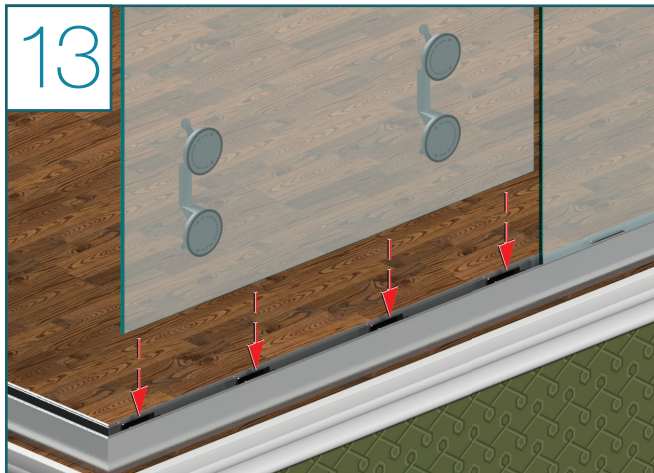

- With the grips in place, refer to your drawings and panel labels
- Use the suction cups to move each panel into place on the base rail

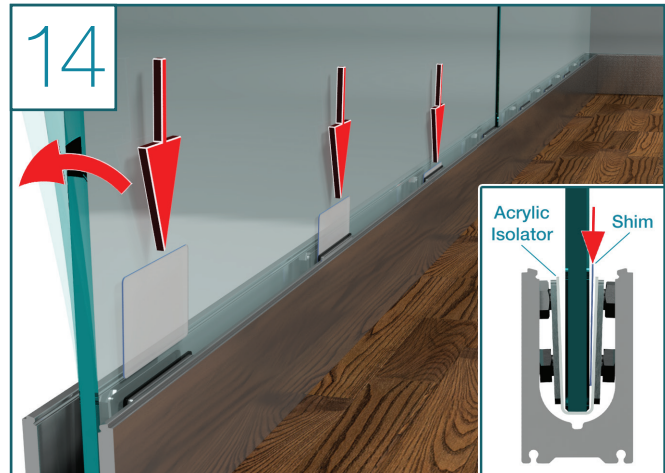

- Slide one shim in between the glass panel and the acrylic isolator
- To do this you may need to tilt the glass towards the opposite side from the base rail that you are placing the shims

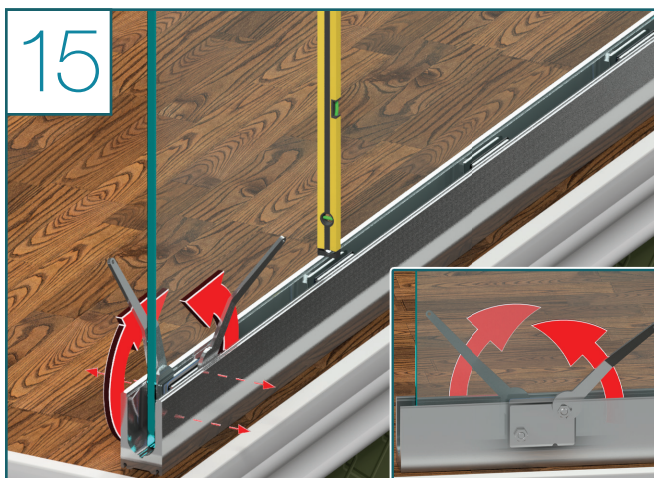

- Adjust the nuts as needed to level the glass
- Adjust the nuts on the opposite side of the plastic shim first (you may need to use the long wrench)
- Tighten these counter clockwise until the panel is level
- Then adjust the inside nuts to start putting pressure on the glass
- Check the level once everything is snug
- Go back to the outside & make sure the nuts are tight

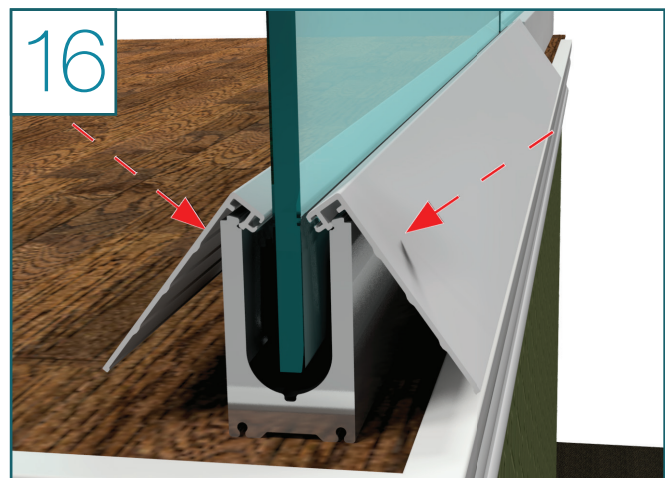

- After the set screws are adjusted, take each cover and clip them into place
- The lip of the cover should lock in place on the inside of the channel
- Tap them down to ensure they are seated properly
- It may be necessary to use a rubber mallet to properly seat the covers

### Glass Base Rail Installation Steps (Continued)

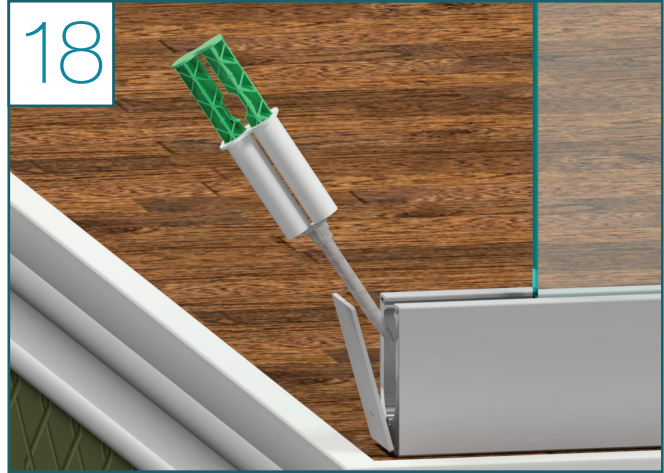
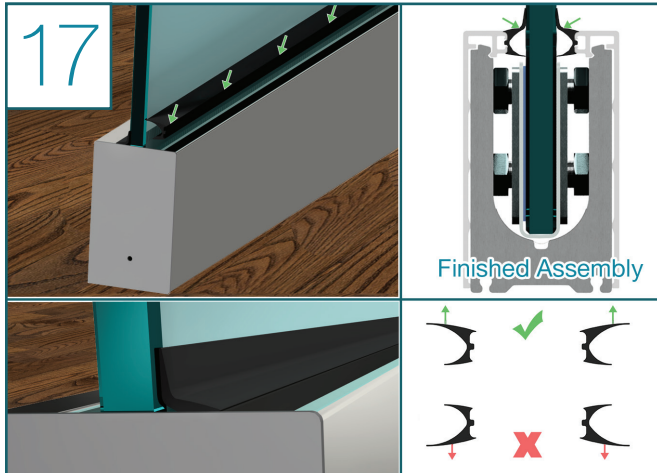

- After the covers are fully seated, locate the Blade Gasket
- Cut the gasket to length for each run using scissors or a knife
- Begin pushing it down inside the channel working from left to right (the long side should be on top and the rounded knob should fit inside the cover extrusion)

- For any exposed end of the Base Rail, attach the Base Rail End Cap
- You can use silicone or epoxy to hold it into place
- Make sure to have the “weep hole” positioned at the bottom of the end cap and no silicone covering it up

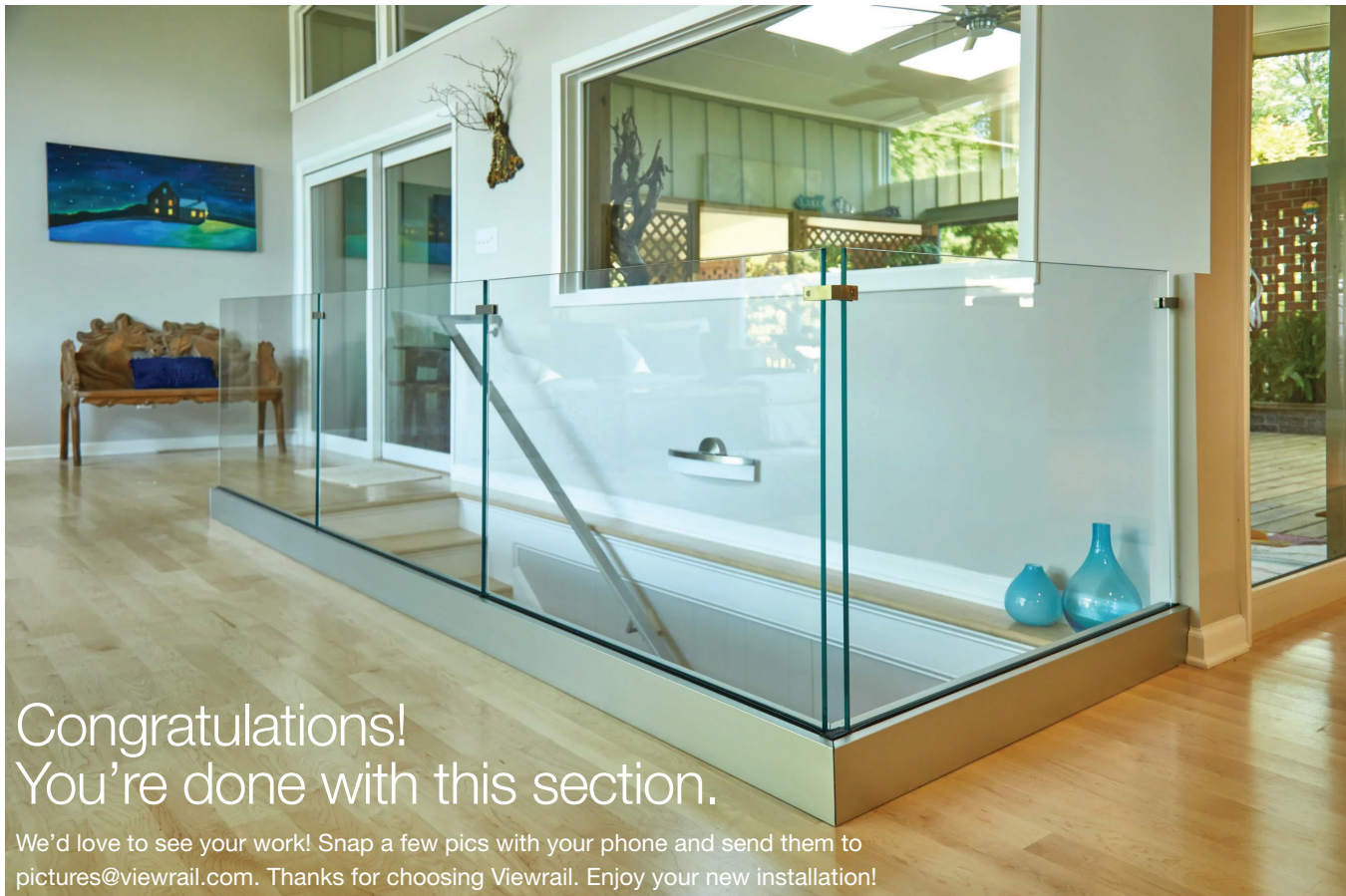

Congratulations!  
You're done with this section.

We'd love to see your work! Snap a few pics with your phone and send them to [pictures@viewrail.com](mailto:pictures@viewrail.com). Thanks for choosing Viewrail. Enjoy your new installation!